

Schaufeln
& Kellen
Scoops
& ladles

8860



Pharmaschaufeln, High-Level-Qualität NEW!

Wandstärke 1,2 mm. GMP-konform. Fugenfremd und hochglanzpoliert.

Pharma scoop, high quality

Wall thickness 1.2 mm. GMP compliant. Free of joints and highly polished.

Material	A	a	B	ca. Ltr	Artikel Nr.
V4A-Stahl	180	100	50	0,10	8860
V4A-Stahl	260	150	75	0,45	8861
V4A-Stahl	365	235	110	1,00	8862
V4A-Stahl	400	250	135	2,50	8863

8800



Chemikalienschaufel, 18/10-Stahl
Chemical scoop, 18/10 stainless steel

Material	A	a	B	ca. Ltr	Artikel Nr.
18/10-Stahl	190	100	50	0,12	8800
18/10-Stahl	250	145	75	0,45	8801
18/10-Stahl	320	190	105	1,00	8802
18/10-Stahl	350	230	120	1,50	8803
18/10-Stahl	370	250	150	2,00	8804

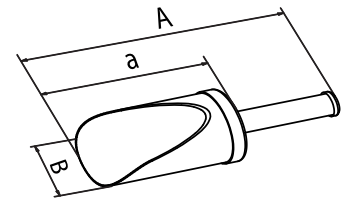

8830



Griff verlötet, besonders hochwertige Verarbeitung.
Handle soldered, extremely high quality processing.



Apotheken-Schaufel, 18/10-Stahl
Pharmacy-Scoop, 18/10 stainless steel

Material	A	a	B	ca. Ltr	Artikel Nr.
18/10-Stahl	220	120	50	0,10	8830
18/10-Stahl	280	165	75	0,40	8831

8809



Griff verschweißt, besonders hochwertige Verarbeitung. Geeignet für Lebensmittel.

Handle welded, extremely high quality processing. Qualified for food.

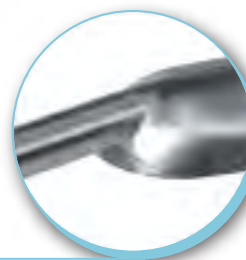

Pharma-Schaufel, 18/10-Stahl Pharma scoop, 18/10 stainless steel

Material	A	a	B	ca. Ltr	Artikel Nr.
18/10-Stahl	215	100	40	0,15	8809
18/10-Stahl	310	160	82	0,25	8810
18/10-Stahl	350	200	102	0,5	8811
18/10-Stahl	390	220	120	1,0	8812
18/10-Stahl	450	300	160	2,0	8813

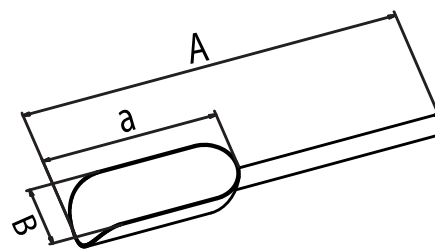

8835



Fugenlose Verbindung von Schaufel und Hohlgriff. Mit Aufhängeöse. Geeignet für Lebensmittel.

Seamless fixed handle, extremely high processing. With hanging loop. Qualified for food.

Pharma-Schaufel, 18/10-Stahl Pharma scoop, stainless steel 18/10

Material	A	a	B	ca. Ml	Artikel Nr.
18/10-Stahl	215	120	60	100	8835
18/10-Stahl	230	140	75	200	8836
18/10-Stahl	245	155	85	250	8837
18/10-Stahl	350	220	130	500	8838



8814

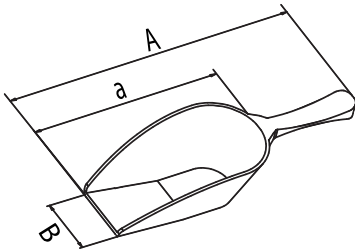

Chemikalienschaufel, Aluminium Chemical scoop, aluminium

Material	A	a	B	ca. ML	Artikel Nr.
Alu	65	40	12	5	8814
Alu	85	52	13	10	8815
Alu	135	80	24	50	8816
Alu	155	95	30	65	8817
Alu	185	115	32	90	8818
Alu	210	120	37	160	8819
Alu	250	145	45	240	8820
Alu	290	175	55	400	8821
Alu	310	185	57	480	8822
Alu	350	220	63	900	8823
Alu	400	270	83	1600	8824
Alu	430	300	95	2500	8825
Alu	250	120	35	90	8827
Alu	285	120	35	90	8828
Alu	365	120	35	90	8829

Wägeschaufel Weighing scoop

Material	A	D	Artikel Nr.
18/10-Stahl	70	32	12800
18/10-Stahl	90	32	12801
18/10-Stahl	105	32	12802
18/10-Stahl	120	32	12803
18/10-Stahl	120	30-65	12804
18/10-Stahl	160	30-75	12805
18/10-Stahl	200	55-100	12806
Alu	70	32	12810
Alu	90	32	12811
Alu	105	32	12812
Alu	120	32	12813



12800

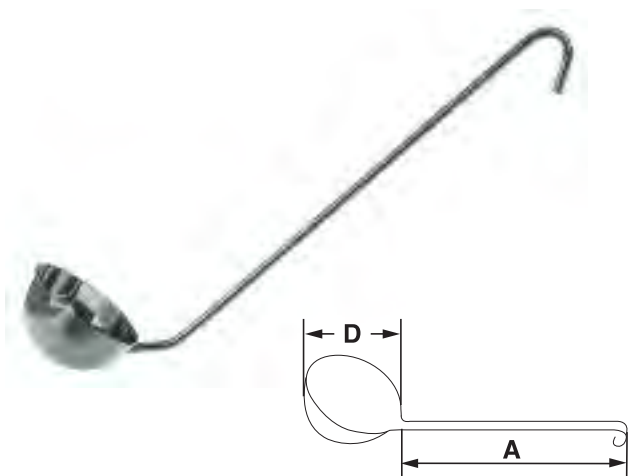
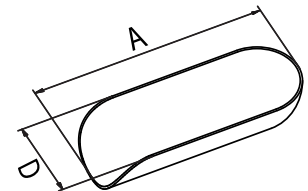

Schöpfkelle, runder Griff Ladle, round handle

Material	A	D	ML	Artikel Nr.
18/10-Stahl	300	60	65	8790
18/10-Stahl	300	70	100	8791
18/10-Stahl	300	80	175	8792
18/10-Stahl	300	90	200	8793
18/10-Stahl	400	100	250	8794
18/10-Stahl	400	120	480	8795
18/10-Stahl	400	140	670	8796
18/10-Stahl	400	160	1000	8797
18/10-Stahl	500	200	2000	8799



8740

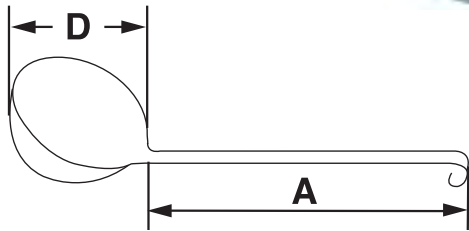

Schöpfkelle, flacher Griff
Ladle, flat handle

Material	A	D	ML	Artikel Nr.
18/10-Stahl	185	70	90	8740
18/10-Stahl	315	90	200	8741
18/10-Stahl	315	100	220	8742
18/10-Stahl	345	140	600	8743
18/10-Stahl	350	160	1000	8744
18/10-Stahl	350	180	1400	8745



3805

Dosierkelle 18/10-Stahl

ml-Angabe erreicht bei Füllung bis zum Rand

Portioning ladle, 18/10 stainless steel

ml indication reached with filling until rim

Material	A	D	ml	Artikel Nr.
18/10-Stahl	125	86	125	3805
18/10-Stahl	145	105	250	3806
18/10-Stahl	165	130	500	3807

